

DO NOT SCALE

A1

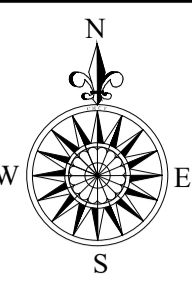

- GENERAL NOTES**
1. ALL DIMENSIONS ARE IN METRES UNLESS NOTED OTHERWISE
  2. ONLY WRITTEN DIMENSIONS SHALL BE USED. NO DIMENSIONS SHALL BE SCALED FROM THE DRAWINGS
  3. ALL LEVELS ARE IN METRES AND ARE TO ORDNANCE DATUM MALIN UNLESS NOTED OTHERWISE
  4. ALL COORDINATES ARE IN METRES AND ARE TO IRISH TRANSVERSE MERCATOR
  5. DRAWINGS ARE TO BE READ IN CONJUNCTION WITH THE SPECIFICATION
  6. ALL DRAWINGS ARE THE PROPERTY OF ATKINS BYRNELOOBY.
  7. [xx.xx m CD] REFER TO LEVELS AT CHART DATUM (DUBLIN PORT)
  8. ORDNANCE DATUM MALIN [O.D.M.]
- CHART DATUM [C.D.] (DUBLIN PORT) 2.51m
9. OS MAP SHEET NO:  
 3198-18, 3198-19, 3198-20, 3198-23, 3198-24, 3198-25,  
 3199-16, 3199-17, 3199-18, 3199-21, 3199-23, 3199-24,  
 3264-2, 3264-3, 3264-4, 3264-5, 3264-8, 3264-9, 3264-10,  
 3264-13, 3264-14, 3264-15, 3265-1, 3265-6, 3265-7, 3265-8,  
 3265-9, 3265-11, 3265-12.

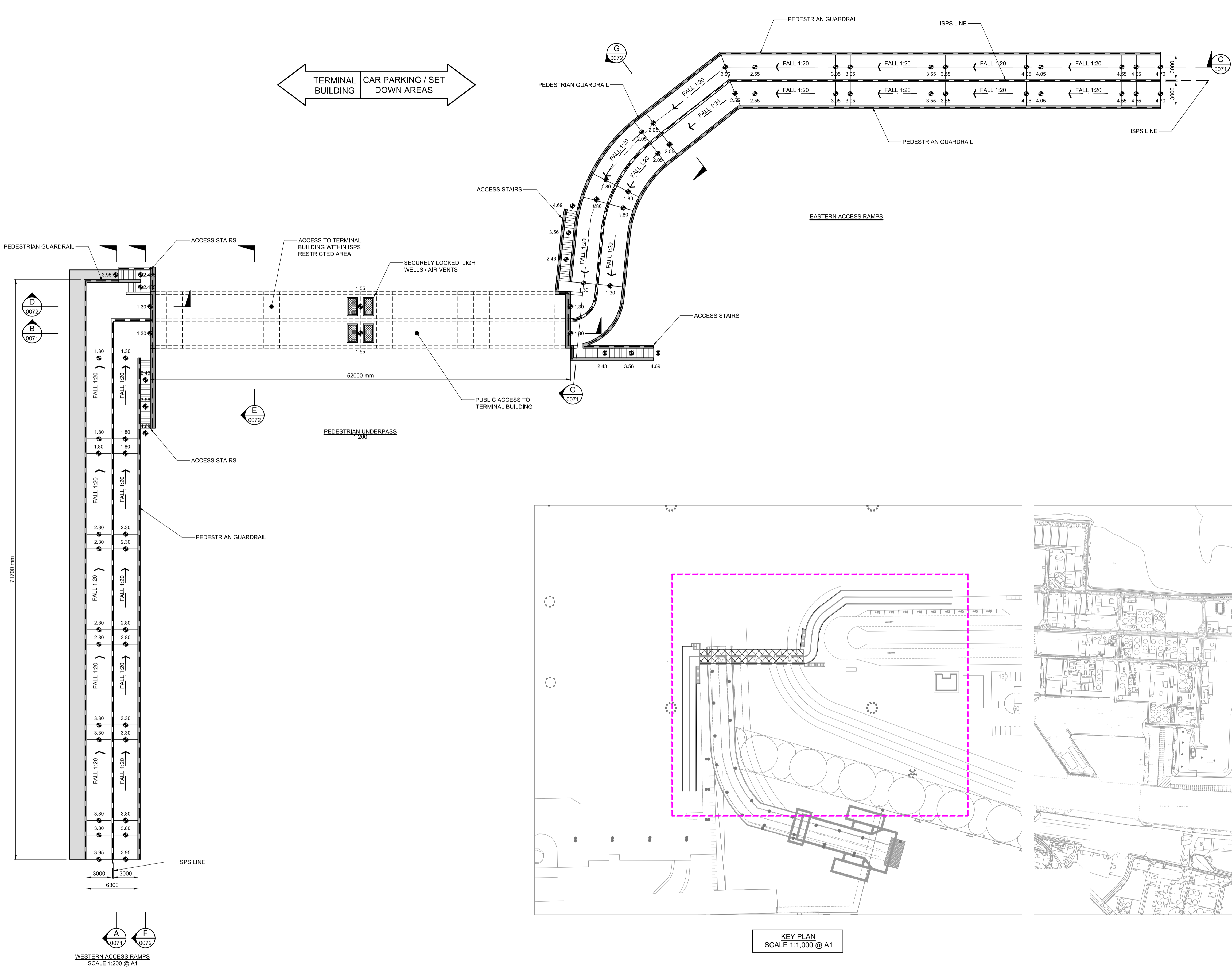
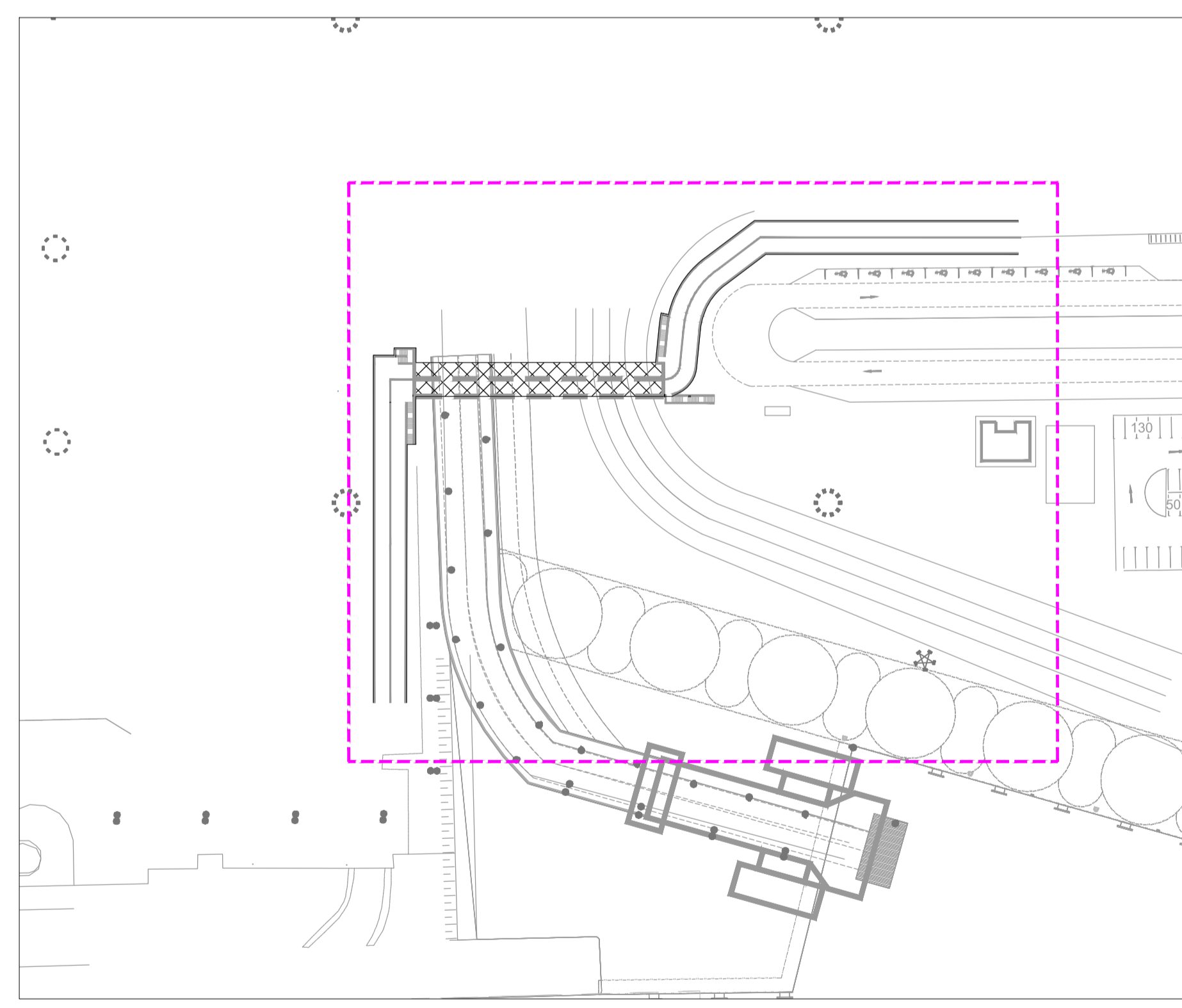

KEY PLAN  
SCALE 1:1,000 @ A1

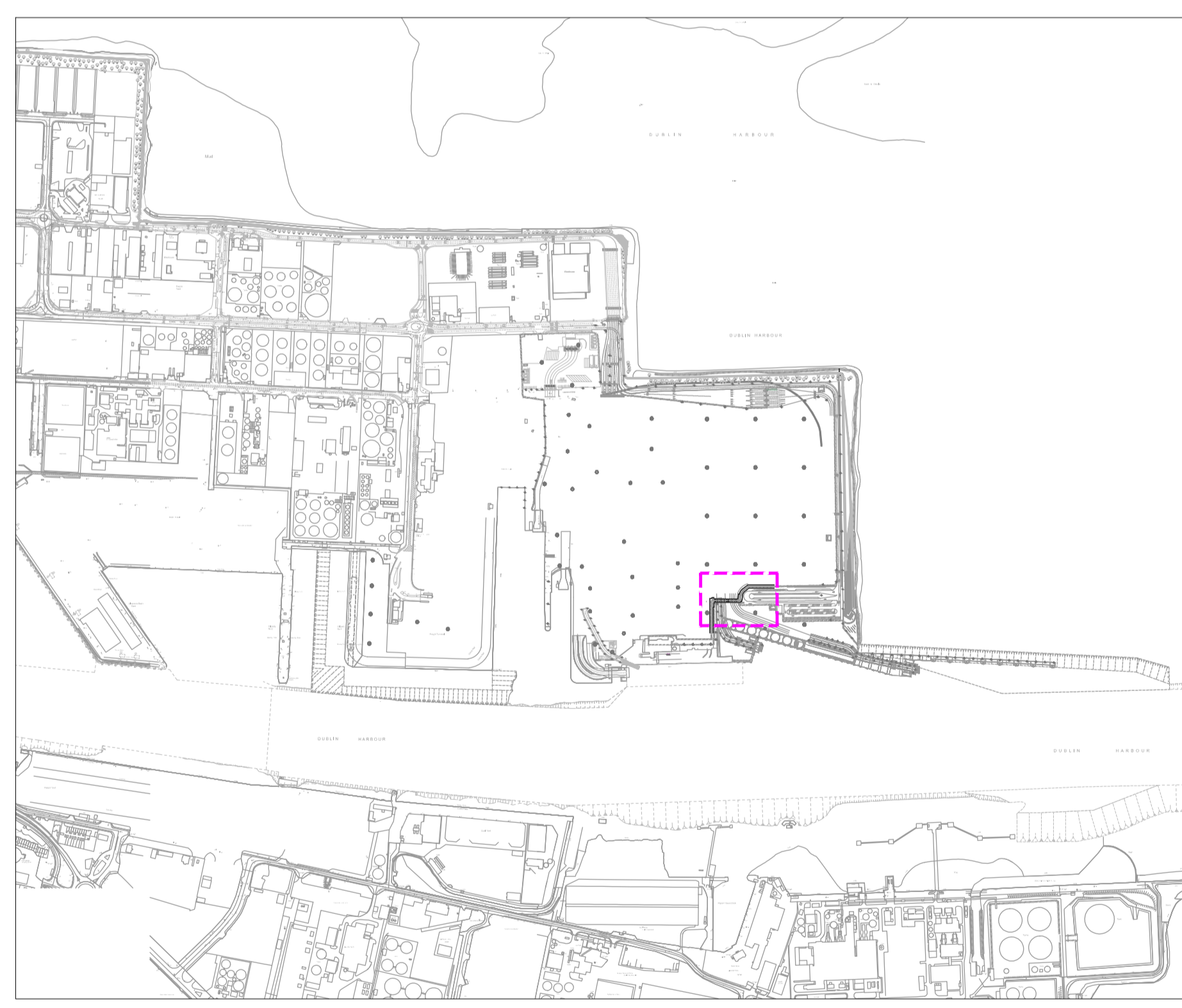

LOCATION PLAN  
SCALE 1:10,000 @ A1

File: CP1770-ATK-01-ZZ-M2-CE-0070-72\_Underpass\_Details.dwg  
Date: Jul 05, 2019 - 4:15pm Plotted by: ENicMhurchu

ATKINS PROJECT No. : 5163122  
 Ordnance Survey Ireland Licence No. AR0082519  
 © Ordnance Survey Ireland/Government of Ireland

Rev	Description	By	Date	Chk'd	Auth
00	ISSUED FOR PLANNING	MOD	07.19	KH	AC

**ATKINS**  
Member of the SNC-Lavalin Group

**BYRNELOOBY**  
WS Atkins Ireland Ltd. & ByrneLooby Partners Ltd.  
Atkins House,  
150 Airside Business Park,  
Swords, Co. Dublin

Client  
**COMHLAUGHT CHALAFOR  
ÁTHA CLIATH  
DUBLIN PORT COMPANY**

Project  
**MP2**

Purpose <b>PLANNING</b>	
Title <b>PEDESTRIAN UNDERPASS LAYOUT PLAN</b>	
Original Scale <b>As Shown @ A1</b>	Design/Drawn <b>AOS</b>
Checked <b>KH</b>	Authorised <b>AC</b>
Date <b>05.07.19</b>	Date <b>05.07.19</b>
Status <b>P</b>	Drawing Number <b>CP1770-ATK-01-ZZ-M2-CE-0070</b>
Rev <b>00</b>	